

Raccolta differenziata
Verifica le disposizioni del tuo Comune

<https://quefairedemesdechets.fr>

Alle Maßangaben sind ca.-Maße und können geringfügig abweichen.
All measurements are approximate and may vary slightly.

Fackelmann GmbH + Co. KG
Sebastian-Fackelmann-Str. 6
91217 Hersbruck • Deutschland
FAX: 09151/811-294
Servicetelefon: 09151/811-206
servicebm@fackelmann.de
www.fackelmann.com

5MIAN809300 S1 12/26

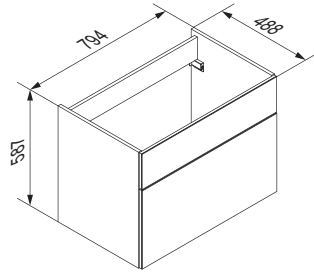

! Alle Maße sind in Millimetern angegeben, unverbindlich, vor Ort zu prüfen und stellen nur eine Empfehlung dar. Änderungen vorbehalten.
 All dimensions are given in millimeters, without obligation, to be checked on site and represent only a recommendation. Subject to change.

1



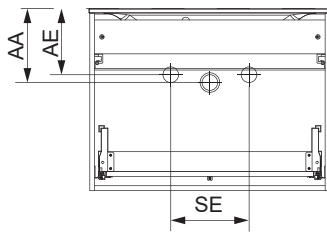
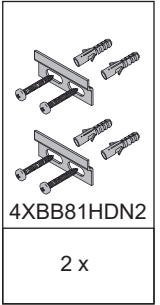
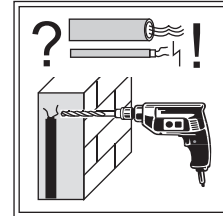
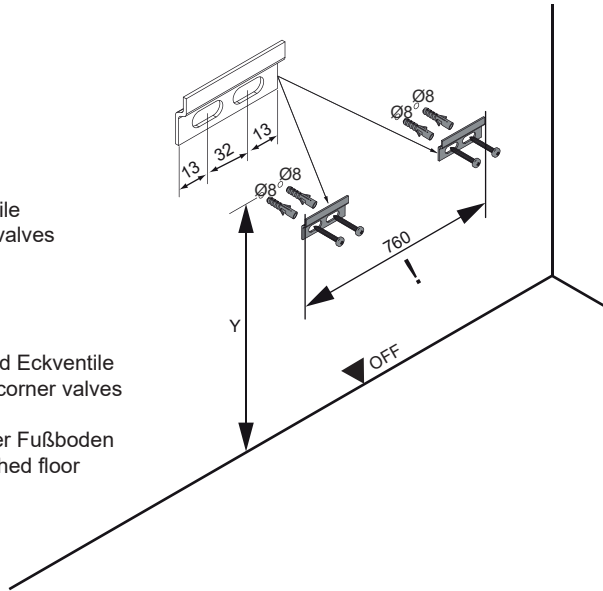

- AE = Abstand Eckventile
Distance corner valves
- AA = Abstand Ablauf
Distance drain
- SE = Seitlicher Abstand Eckventile
Lateral distance corner valves
- OFF = Oberkante fertiger Fußboden
Top edge of finished floor

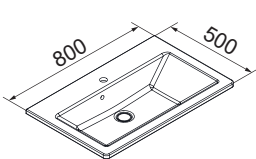
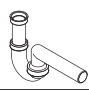
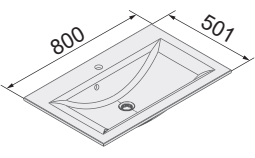
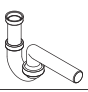
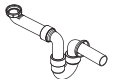

900

Ansicht von hinten
View from the back

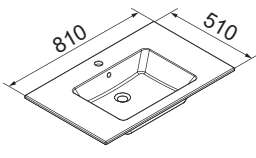
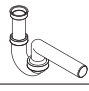
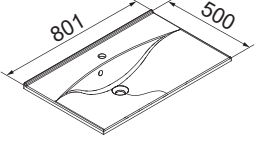
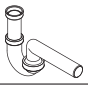
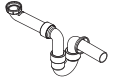
OFF

Washbecken / Wash basin	AA	AE	SE	Siphon	Washbecken / Wash basin	AA	AE	SE	Siphon
	290 - 460	290 - 460	150 - 330	Bei Standard-Siphon With standard siphon 		260 - 450	260 - 450	150 - 330	Bei Standard-Siphon With standard siphon 
	310 - 490	290 - 460	150 - 330	Bei Raumspar-Siphon With Space-saving siphon 		280 - 480	260 - 450	150 - 330	Bei Raumspar-Siphon With Space-saving siphon 
	280 - 450	280 - 450	150 - 330	Bei Standard-Siphon With standard siphon 		275 - 465	275 - 465	150 - 330	Bei Standard-Siphon With standard siphon 
	300 - 480	300 - 480	150 - 330	Bei Raumspar-Siphon With Space-saving siphon 		295 - 495	295 - 495	150 - 330	Bei Raumspar-Siphon With Space-saving siphon 

2

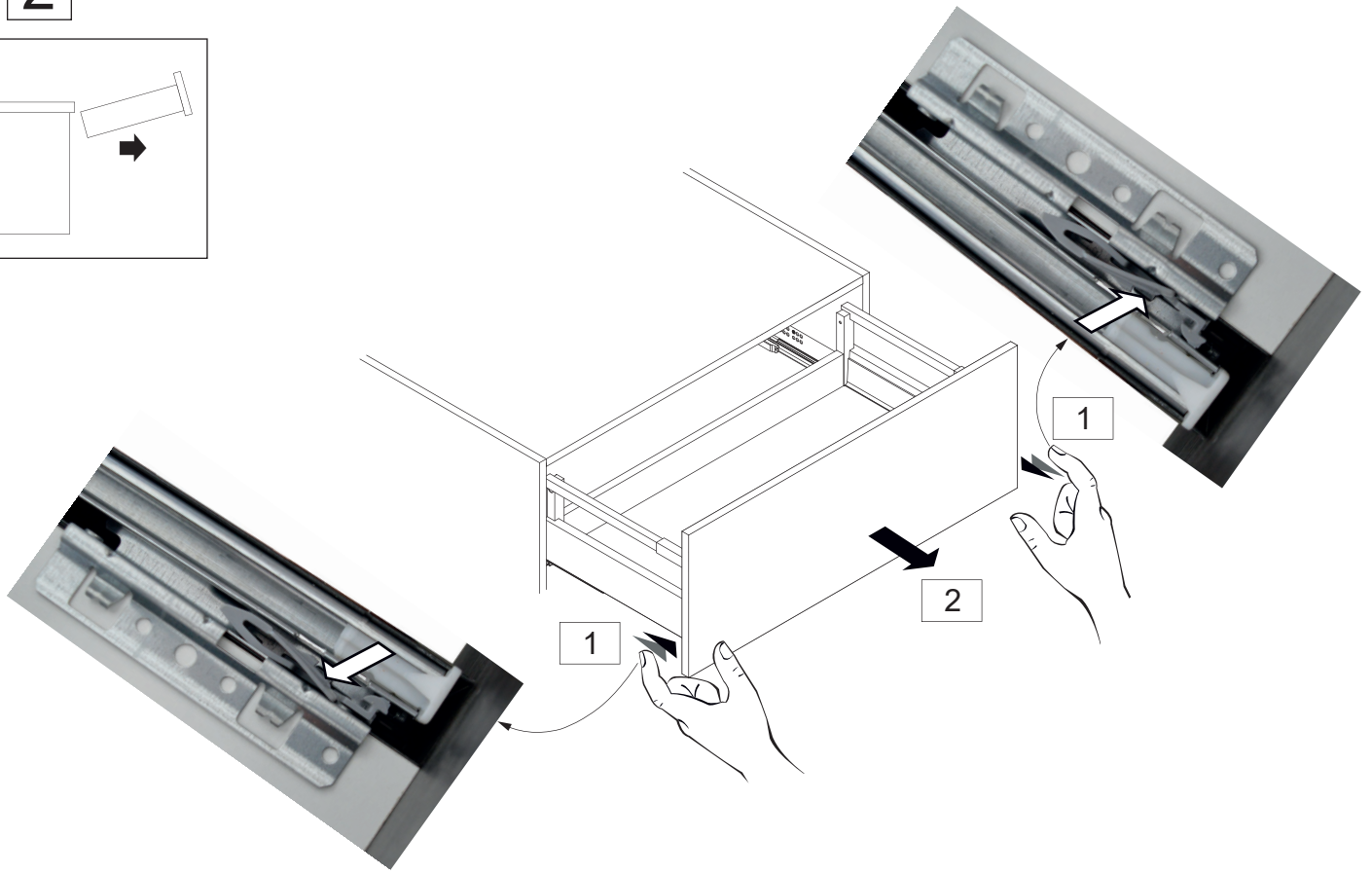
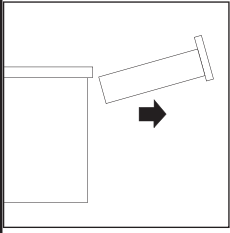

 Youtube-Video
 Ausbau und Einbau der Schublade
 Removal and Installation of the drawer

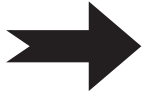

3 3.1 2x

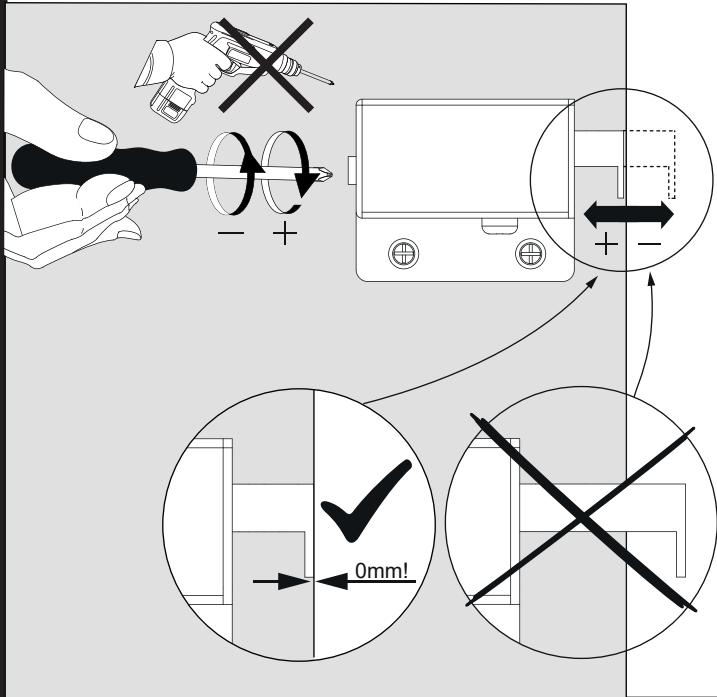

3.2 2x

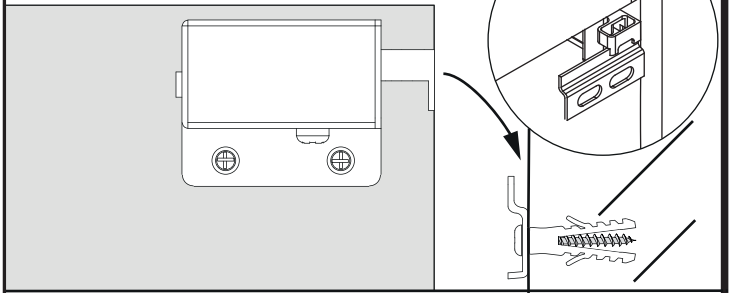

3.3 2x

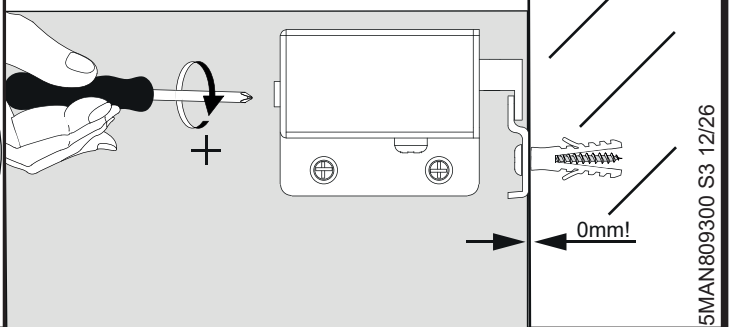

4

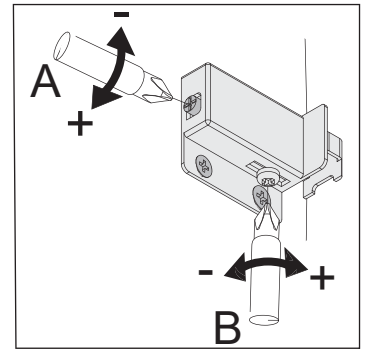
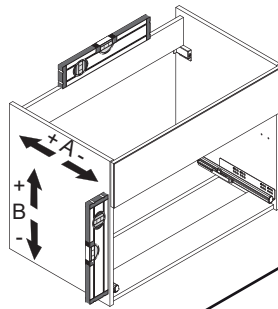

5



Zusätzliche Wandbefestigung für Waschtischunterschranke und Beckenunterschranke zur Einhaltung der Norm EN 14749 unbedingt einbauen! Beigefügtes Wandbefestigungs-Material ist nur für Massivwände geeignet. Zur Befestigung an anderen Wänden müssen Spezialdübel verwendet werden.

In compliance to the norm EN 14749 please make sure to built-in the additional wall-fastenings for sink cabinets and vanities. Attached wall-fastening-material is for massive walls only. For mounting on all other walls please use special dowels.

Maße bauseits prüfen!
Check dimensions on site!

⚡ Wasserleitungen
Water pipes

▼ OFF

5.1

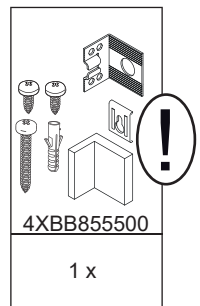
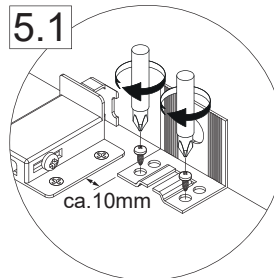

5.2

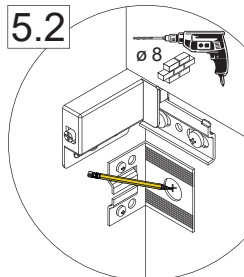

5.3

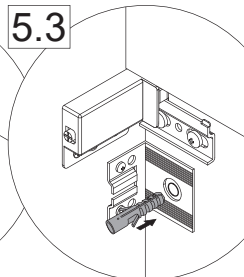

5.4

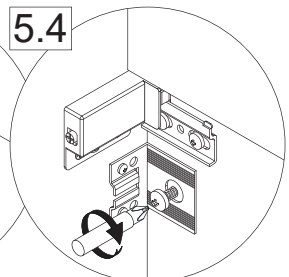

5.5

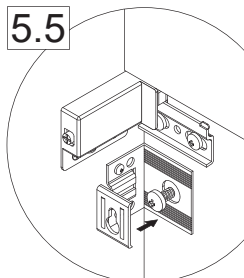

5.6

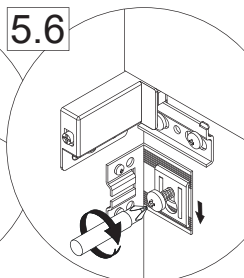

5.7

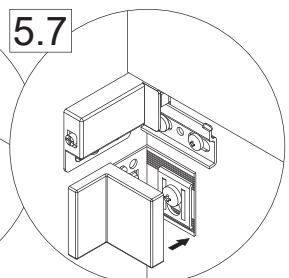

6 6.1

i Silikon nicht inklusive
Silicone is not included

6.2



24 h

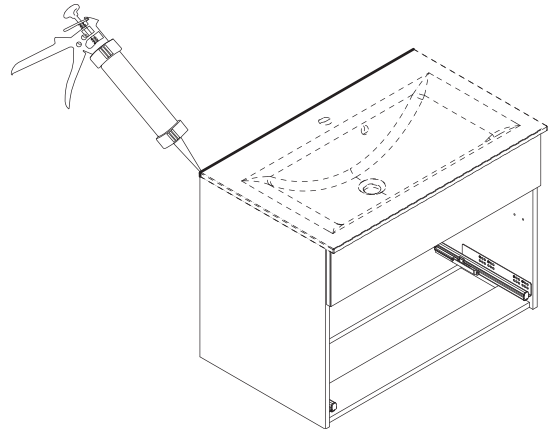
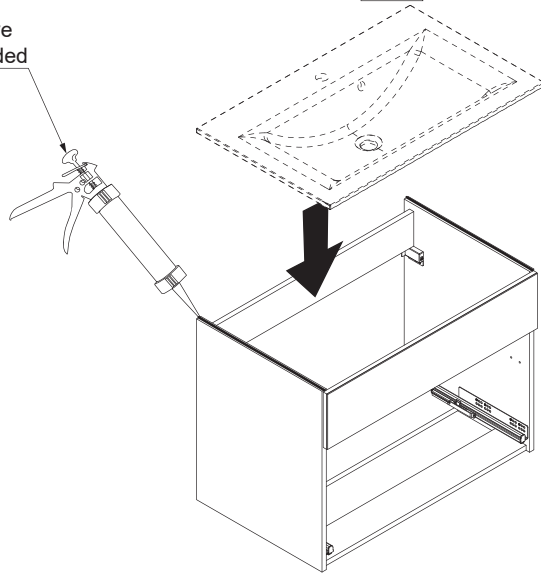

7

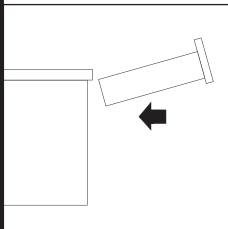

i Youtube-Video
Ausbau und Einbau der Schublade
Removal and Installation of the drawer

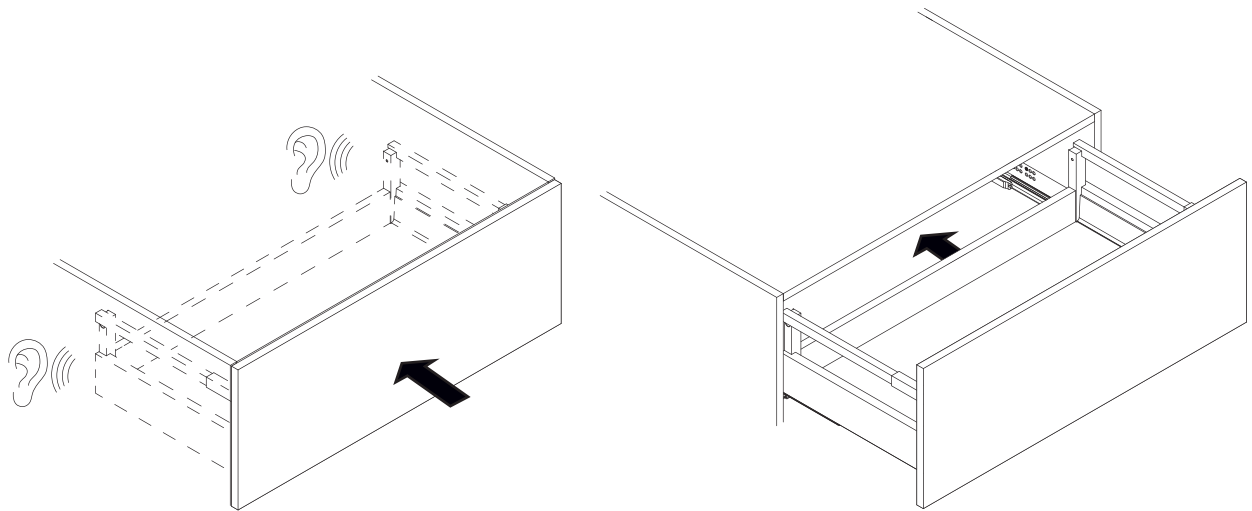
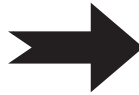

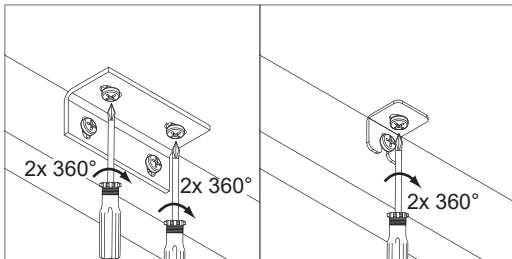
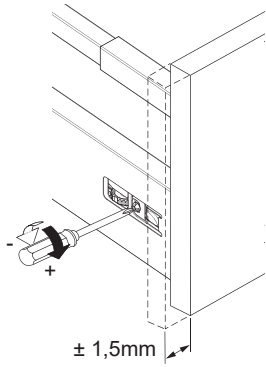
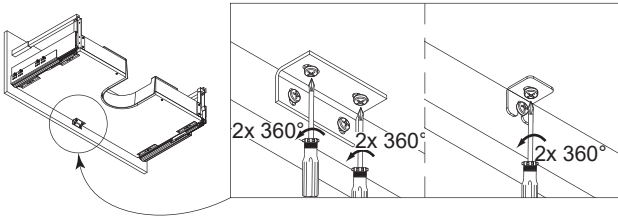
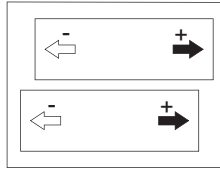
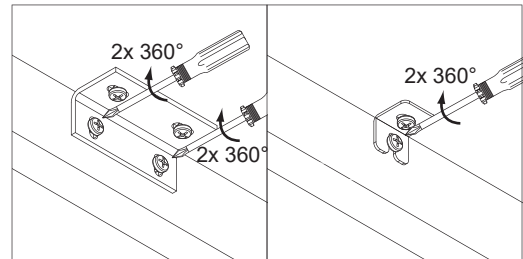
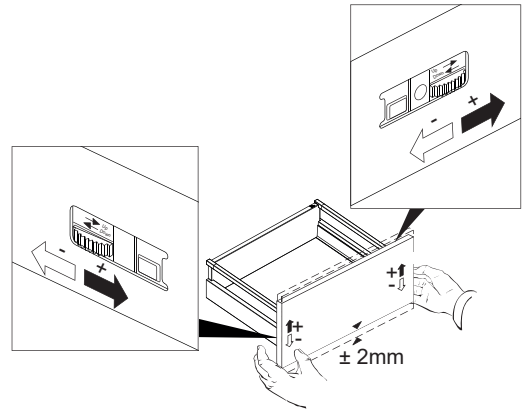
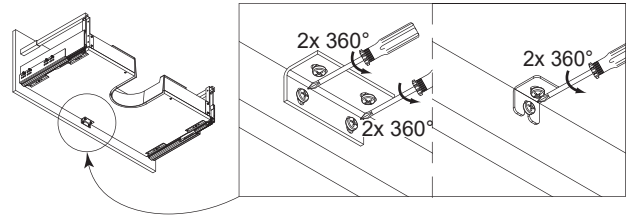
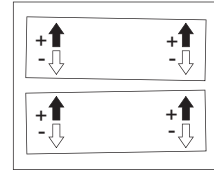
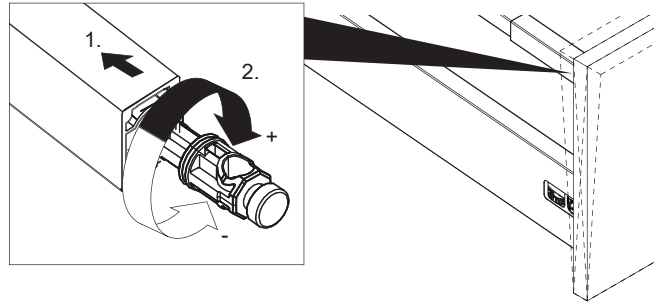
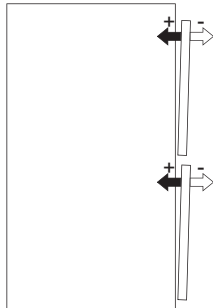
A**B****C****D**